

LE LYRIAL

WELCOME
ABOARD

JULY 2015

DESIGN
An exceptional yacht

JOURNEYS
Sail to the Mediterranean and Antarctica

LIFE ABOARD
The "French Touch"



04

A NEW JEWEL IN PONANT'S FLEET



06

DESIGN



08

NATURE



10

LIFESTYLE ON BOARD



12

JOURNEYS



15

DECK PLAN

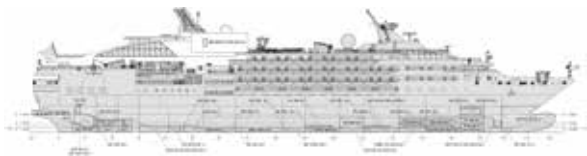

LE LYRIAL, A NEW EXCEPTIONAL YACHT

Born under a lucky star. Never has this expression been truer when presenting a new ship. We might even say ours was born under lucky stars, given the number of stars that have shone over Le Lyrial's fate.

One of those is the Lyra, a northern hemisphere constellation whose largest star, Vega, will be the next North Star. The Vega's dazzling blue light makes it one of the brightest stars in the sky.

And Le Lyrial will be sure to follow its lead. This versatile ship is happy sailing any sea or ocean around the world and will take its inaugural cruise around the Mediterranean. However, like the other PONANT sisterships, she has been specially designed for exploring the polar regions. This winter, the newest addition to our fleet will set sail from Ushuaia to offer its passengers the unique experience of travelling through the icy landscapes of Antarctica.

Born under a lucky star: the link is not purely etymological in the case of Le Lyrial. During her launching ceremony on 23 October 2014 in Ancona, Italy, the ship's godmother Virginia GOHAGAN placed a coin in the hull. From the 2014 Monnaie de Paris collection, this coin represents the Pourquoi Pas?, the famous ship sailed by French Captain CHARCOT during his pioneering polar exploration.

This sees Le Lyrial take its place in the lineage of great ships dominated by character, daring and style. These qualities are evident in this ship and enable us to continue writing new chapters in French sailing history.

We are proud to share these exciting times with you.

Véronique SAADÉ
Deputy CEO

Jean-Emmanuel SAUVÉE
President and Co-founder



LE LYRIAL, A NEW JEWEL IN PONANT'S FLEET

Le Lyrial set sail on 9 May 2015 from Venice. Like Le Boréal (2010), L'Austral (2011) and Le Soléal (2013) before her, this new sistership is ready to write a new chapter in PONANT history.

A light hull, an exquisitely slender bow and sleek lines... Le Lyrial created a sensation at the Fincantieri shipyard in Ancona, Italy on Thursday 23 October 2014. This ship does indeed raise the bar set by the qualities that built PONANT's reputation.

With her intimate size, streamlined elegance and luxury materials, Le Lyrial truly embodies the art of Yacht Cruises & Expeditions. Refinement, subtlety, elegance and simplicity effortlessly run through each of the ship's 122 staterooms and suites, and every living and relaxation areas. Giving her passengers the feeling of sailing on a private yacht, this subtle blend of luxury, intimacy and wellbeing is a priority in Five-Star settings.



Aboard Le Lyrial, the interior has been created by French interior architect & designer Jean-Philippe NUEL in close collaboration with Véronique SAADÉ, Deputy CEO. Every effort has been made to respect the independence and tastes of each guest: two restaurants, two indoor bars and one outdoor bar, a relaxation area on the pool deck, lounges, a theatre for conferences, film screenings and shows, a spa, a library, an internet area, an entertainment area with Wii® consoles and board games, and intimate nooks everywhere for chatting or relaxing in peace.

Passengers on Le Lyrial will fall in love with ocean life while enjoying luxury comfort. Our ship and crew will take guests on journeys to lands they have only dreamed of: Italy, Croatia, Montenegro, Greece, Turkey... and the icy Antarctica.



PATRICK MARCHESSEAU, CAPTAIN OF LE LYRIAL

Since 2004, Patrick MARCHESSEAU has shared his passion for the sea with PONANT passengers. At the helm of Le Lyrial, he looks forward to taking passengers on extraordinary adventures that only a ship of this calibre can offer.

You are taking the helm of Le Lyrial. What is special about this ship?

This ship, just like her sisterships, is a jewel of high-technology, comfort and elegance. Her great advantage is her small scale, with 139 crew members for 244 passengers, which allows us to offer Five-Star services. Le Lyrial is perfect for traditional cruises such as those we will have in the Mediterranean this summer, mainly from Venice, but also for Expedition cruises next winter in Antarctica. With her fleet of 12 Zodiac®, passengers disembark in the ice itself, being closer to the nature of the polar regions. The comfort is guaranteed even in extreme zones. I am proud to be at the helm of such a ship.

Which PONANT destination impressed you the most ?

I get a thrill out of exploration so I have a soft spot for our expedition cruises. My favorite destination is Antarctica. From one year to the next, the conditions are never the same, it is always an amazing adventure and the opportunity to observe the animals close up. This is truly a unique and extraordinary moment.

Is that what PONANT is, a succession of magical moments?

Yes, I believe that in my heart. Living in the moment is at the heart of our cruising philosophy. It is what enables the captain and expedition leader to alter the itinerary for safety reasons or passenger wishes. It is also what makes me wake up the passengers at 4.30am to see the amazing reflections on the sea and ice floes. And this PONANT spirit also justifies leaving an hour later because three curious humpback whales come close to the marina in the Gerlache Strait. PONANT moments like those are unforgettable.



Following in the footsteps of her sisterships, Le Lyrial's interior design was entrusted to Jean-Philippe NUEL. He worked in close collaboration with Véronique SAADÉ, PONANT Deputy CEO. We talked to them about this partnership that has carved out, ship after ship, in the company's unique style.



Le Lyrial is the fourth ship you have collaborated on. Would you say PONANT now has a signature style?

Véronique SAADÉ: I think so. We wanted our company's personality to be reflected in this unique fleet's design, as it is reflected in our cruises and our global philosophy.

Jean-Philippe NUEL: We worked with this in mind and the ships' design was created in such a way as to express the comfort and intimacy of a private yacht with its subtle blend of elegance and relaxation.



How does that emerge?

V. S.: For me, the convergence point is a certain idea of luxury. A modern, welcoming spirit but one that is aware of its heritage. A new approach of cruising.

J-P. N.: Yes, and the coming of age of Five-Star hotels also represents this new approach which inspires me greatly in my work with PONANT.

How does Le Lyrial stand out from the company's other sisterships?

V. S.: We have accentuated the qualities of previous sisterships both in terms of lightness and brightness. We tried to blend natural elements a bit more - water, sky, light and minerals.

J-P. N.: And of course the colour range with its dominating blue evokes Le Lyrial's destinations. A delicate palette connects the soft grey, bright tones of polar ice with the vibrant, turquoise shades of Mediterranean coves.

On a more personal note, is there one feature in Le Lyrial that you are particularly proud of?

J-P. N.: I would have to say the Owner's Suite, where the mix of fabrics creates a deep atmosphere that leaves an impression. I also really like the gastronomic restaurant's ceiling which was the result of meticulous cut-out work to depict a constellation.

V. S.: Personally, I love the cameos mentioned earlier. The panoramic exudes an atmosphere I find very special, soft, bright and warm.



THE
P
D
T
A
Z



FROM ONE POLE TO ANOTHER: RESPECTING THE ENVIRONMENT

Discover the treasures of the World by sea: PONANT's cruise concept will see Le Lyrial travel to the most beautiful — and often untouched — regions including Antarctica with its wealth of exceptional, preserved locations. It is the responsibility of us all — ship builders, crew and passengers — to protect these natural gems. That is why PONANT's priority is respecting the environment. From ship design to shore excursions, everything is done to reduce the company's impact on the environment. Itineraries are carefully crafted, coatings are selected to minimise air and water pollution, and crews and passengers are educated about responsible on board and on shore behaviour. Respecting the environment is a priority for PONANT.

LE LYRIAL, A CERTIFIED "CLEANSHIP"

All of the PONANT's sisterships have been awarded the international "CLEANSHIP" label in recognition of the company's environmental efforts and the ships' innovative, eco-friendly equipment. This includes dynamic positioning to avoid anchoring (protecting sea floors), silent and economical electric propulsion, diesel engines that can operate with the lighter, less polluting MDO (Marine Diesel Oil), innovative wastewater and sewage treatment on board systems on board, reduced exhaust emissions, low energy bulbs and more.





LIFESTYLE ON BOARD

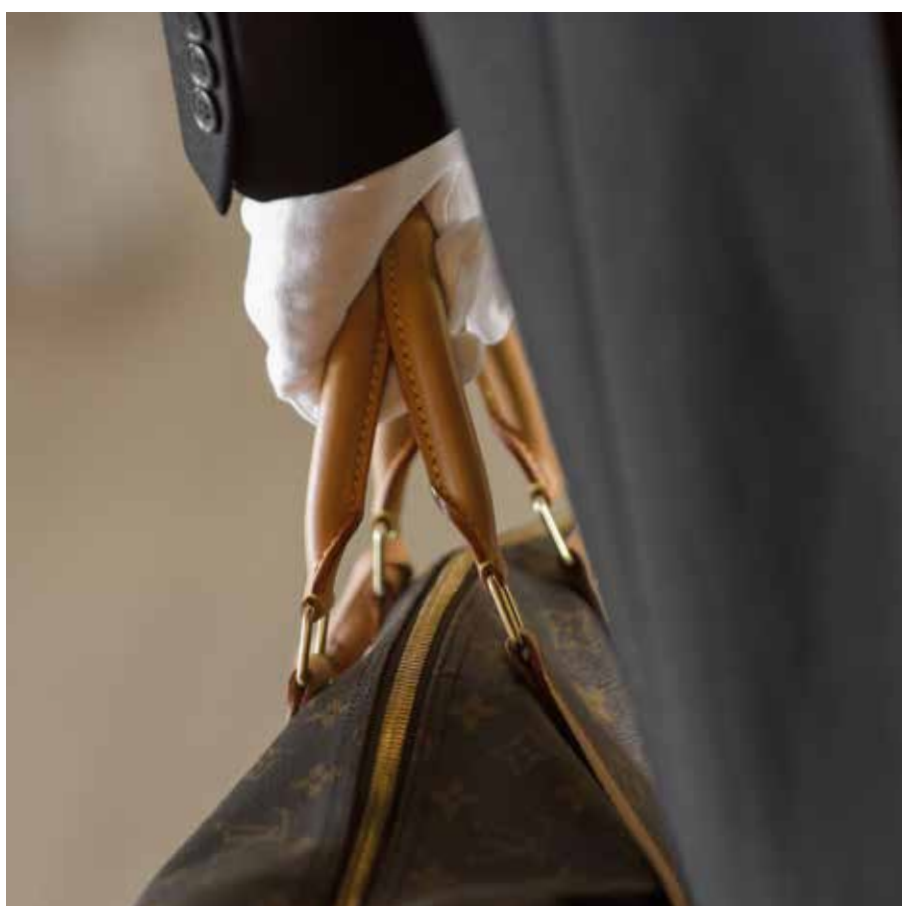

FINE DINING: A JOURNEY WITHIN A JOURNEY

Enjoy elegant, discreet service. Savour an inspired, refined and varied cuisine. In the kitchen, a team of 25 work to offer Le Lyrial's passengers a journey into the realm of flavours, orchestrated by the head chef, sous chef, pastry chef, baker and butcher. On Deck 2, a gastronomic restaurant pays homage to the best of French savoir-faire with menus that subtly fuse the greatest traditions with culinary innovation. With its more relaxed buffet style of dining, the restaurant on Deck 6 offers an other option of French cuisine. Guided by our Corporate Chef, Alain MORVILLE, PONANT takes pride in adapting menus to the countries we visit. Cherries from Kotor, rainbow trout from Nunavut and beef from the Argentinean Pampa: at each port the best ingredients are carefully selected and sourced from local producers. All that remains is to match the dishes to fine wines or vintages from the wine list. Our two sommeliers on board Le Lyrial will ensure you choose the perfect harmony.

DISCREET AND ATTENTIVE SERVICE

Service quality can be measured by various standards. But for PONANT there is only one: excellence. Excellence in hosting, attentiveness and services. From trips in a Zodiac® to the Majordome service, reserved for Deck 6 suites, the quest for perfection guides the work and attitude of every Lyrial crew member. Nothing in this concept of service is done on automatic. Excellence is also — and perhaps particularly — found in those "little nothings", this "je ne sais quoi" and this French touch that gives soul to the impeccable professionalism. Le Lyrial's crew cultivate a subtle atmosphere where elegance blends with simplicity and distinction with authenticity.



BEAUTY & WELLBEING

In an elegant, intimate setting, choose from a comprehensive range of treatments for the wellbeing of your body — and soul. The result of a collaboration with Sothys™, a French brand that has become a global leader in spas and beauty institutes, the beauty salon offers a space where our passengers can put themselves in the hands of experienced therapists. Enjoy moisturising facial treatments, exfoliation, aromatherapy baths and detox sessions. A sauna and L'Oréal Professionnel® hair salon alongside the beauty treatment and massage area offer even more benefits.

ENTER THE SOTHYS™ WORLD

For over 60 years, the highly specialised brand Sothys™ has always stood out with its extraordinary commitment to research and innovation. It claims its place as an avant-garde beauty expert.

 **SOTHYS**
PARIS



In the fitness centre featuring Technogym® equipment including the Kinesis Wall®, large windows look out over the sea letting your eyes and mind sail onwards to the horizon.

 **PONANT**
yacht spa





JOURNEYS

In the early morning, step ashore in the mineral silence of a slumbering Dubrovnik. Tread on an Antarctica ice sheet for the first time or discover in the hollow of a huge glacial valley... 400,000 King penguins. Aboard Le Lyrial, passengers enjoy unique voyages and short break experiences where the exceptional meets the exclusive and unusual.

IN SUMMER, SET SAIL FOR THE MEDITERRANEAN

During the cruise, you can dive off the boat for a swim in the bay's crystal-clear waters or enjoy a concerto in the heart of the Aegean Sea. Discover or rediscover the Mediterranean in a new way.

In summer 2015 and 2016, the ship sails the waters of the Adriatic, Aegean Sea and the Mediterranean. From Italy to Turkey, via Croatia, Montenegro and Greece, the coastline is punctuated by a multitude of coves. Le Lyrial stops to enjoy sunsets over the Bay of Kotor and explore little-known ports.

The surprise-filled itineraries are complemented by exceptional encounters with well-known people who love to share their knowledge and passion in an intimate, accessible way with passengers.



Le Lyrial in the Corinth Canal



THEME CRUISES

Family, gastronomic, musical and more: Le Lyrial also offers a number of theme cruises with special programmes both on board and ashore during stopovers, with exceptional guests, golf courses, prestigious concert halls, iconic museums and more.

Discover in 2015 and 2016:

- Three "Musical cruises" (Venice - Athens in September 2015, Istanbul - Athens in October 2015, Civitavecchia - Dubrovnik in April 2016)
- Three "Family cruises" (Civitavecchia - Athens, Dubrovnik - Athens and Venice - Venice in August 2015)
- A "Gastronomic cruise" (Athens - Venice in August 2015).
- And from 11 to 18 October 2016, PONANT presents an exceptional cruise, based on « Migrations Divines », an exhibition curated by the French museum MuCEM, dedicated to European and Mediterranean civilizations. Along with the curator present on board Le Lyrial, the passengers enjoy in situ some of the masterpieces featured in this exhibition on antiquities polytheism.



DURING WINTER, FIVE-STAR EXPEDITIONS TO THE HEART OF ANTARCTICA

"Whales to the port bow!" The captain's voice rings out through the icy air. In one movement, the passengers all rush to the port side. Ahead a whale is diving into Antarctica's icy waters, offering an amazing spectacle with its large, strong tail which slowly slips away into the depths. For a few seconds everyone holds their breath. Welcome to the South Pole.

Deception Island, Port Charcot and South Georgia: places that have long made explorers both tremble and dream. Today, still only a handful of ships can reach their shores. That is what makes PONANT exclusive, as for 15 years we have made the poles our speciality. Every winter, we take passengers to legendary locations for a genuine polar safari seeking out unique fauna in its natural habitat.



The intensity of a real expedition in Five-Star comfort and this extra touch that make these voyages the experience of a lifetime.



From November to March (2015/2016 and 2016/2017 winters), Le Lyrial sails the icy water of the legendary white continent, the Falklands and South Georgia. Passengers can experience the intensity of a true expedition... in Five-Star comfort and with the spirit that makes these voyages an experience of a lifetime.

Expedition cruises to Antarctica are some of Captain Patrick MARCHESSEAU's favourite itineraries: "No two Antarctica cruises are the same: the environment changes as well as the vistas. After five seasons in Antarctica, every time I still discover new itineraries, new places to step ashore. And our encounters with the fauna are always surprising: penguins, whales, orca... You might see them for a minute or spend an hour with them. In these regions, nature is king and we must bow to it."

DECK PLAN

DECKS

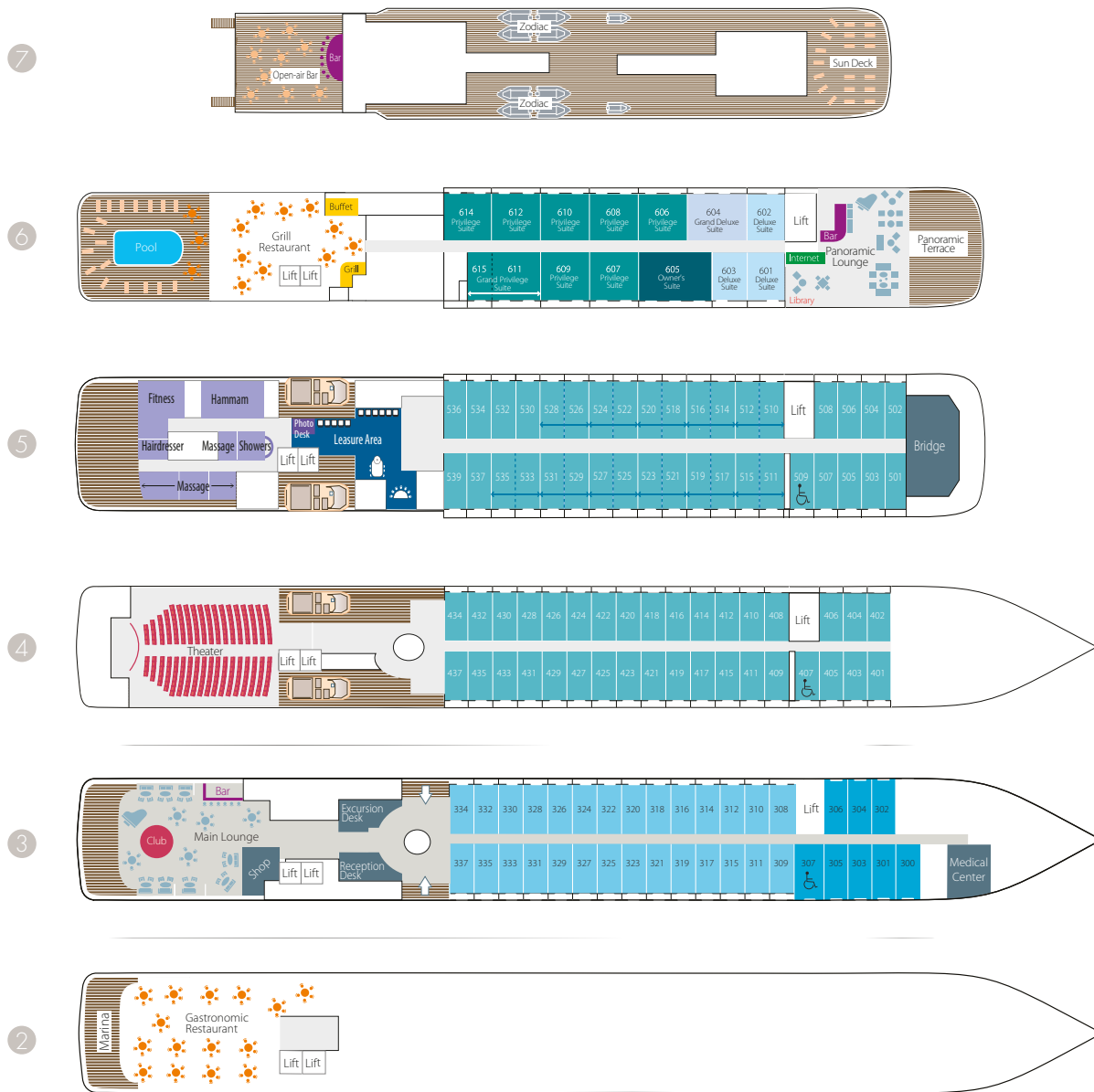

- Owner's Suite Deck 6
- Privilege Suites Deck 6
- Grand Privilege Suite Deck 6
- Prestige Suites Deck 5
- Grand Deluxe Suite Deck 6
- Deluxe Suites Deck 6
- Prestige staterooms Decks 4 - 5 - 6
- Deluxe staterooms Deck 3
- Superior staterooms Deck 3



- 2 Gastronomic Restaurant - Marina
- 3 28 Deluxe staterooms with private balcony - 8 Superior staterooms - Main Lounge - Shop - Reception Desk - Shore Excursions Desk - Medical Centre
- 4 35 Prestige staterooms with private balcony - Theatre
- 5 37 Prestige staterooms with private balcony (with 22 Prestige staterooms convertible into 11 Prestige suites) - Fitness - Sothys™ Beauty Corner: 4 Massage Cabins, Hammam, Hairdresser - Leisure Area - Image & Photo Corner - Bridge
- 6 Owner's Suite - 3 Deluxe suites with private balcony - 1 Grand Deluxe Suite - 8 Privilege Suites - 1 Prestige Stateroom - Pool - Grill Restaurant - Internet Station - Library - Panoramic Lounge - Panoramic Terrace
- 7 Open-air Bar - Sun Deck

STATEROOMS & SUITES

OWNER'S SUITE
(581 sq.ft + 129 sq.ft. private balcony)

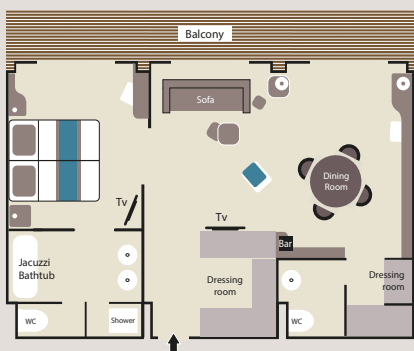

GRAND PRIVILEGE SUITE
(581 sq.ft + 129 sq.ft. private balcony)

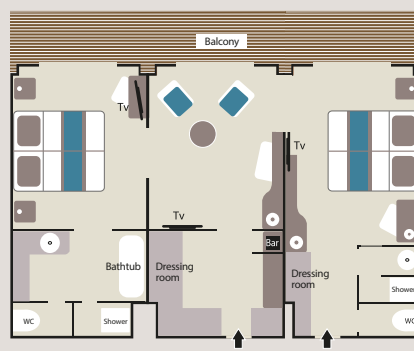

GRAND DELUXE SUITE
(484 sq.ft. + 108 sq.ft. private balcony)

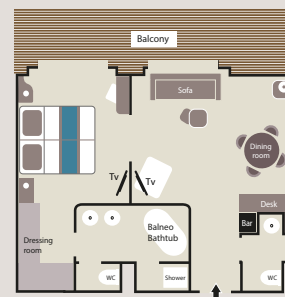

8 PRIVILEGE SUITES
(388 sq.ft. + 86 sq.ft. private balcony)

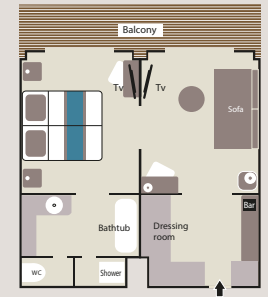

11 PRESTIGE SUITES
(388 sq.ft. + 86 sq.ft. private balcony)

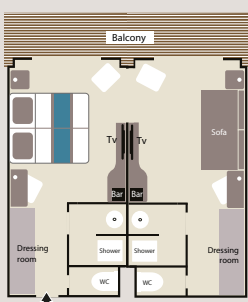

73 PRESTIGE STATEROOMS
(199 sq.ft. + 43 sq.ft. private balcony)



28 DELUXE STATEROOMS
(199 sq.ft. + 43 sq.ft. private balcony)

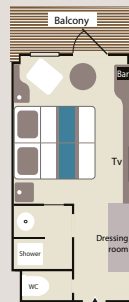

3 DELUXE SUITES
(291 sq.ft. + 65 sq.ft. private balcony)

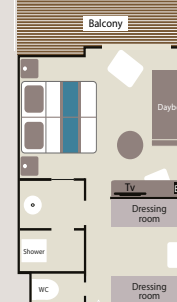

8 SUPERIOR STATEROOMS
(226 sq.ft.)

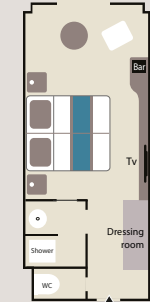

INFORMATION & BOOKING

Please contact your Travel Agent
or PONANT at 1 300 737 178 (from Australia)
0800 44 32 62 (from New Zealand)

PONANT MEDIA CONTACTS

Michael CORBETT
Public Relations Manager
(+61-2) 4360 1116
Mobile: 0417 469 228
michael.corbett@bigpond.com

www.ponant.com

